

Designs released for Cranbourne Community Hospital

Julia Oxley, General Manager, Community

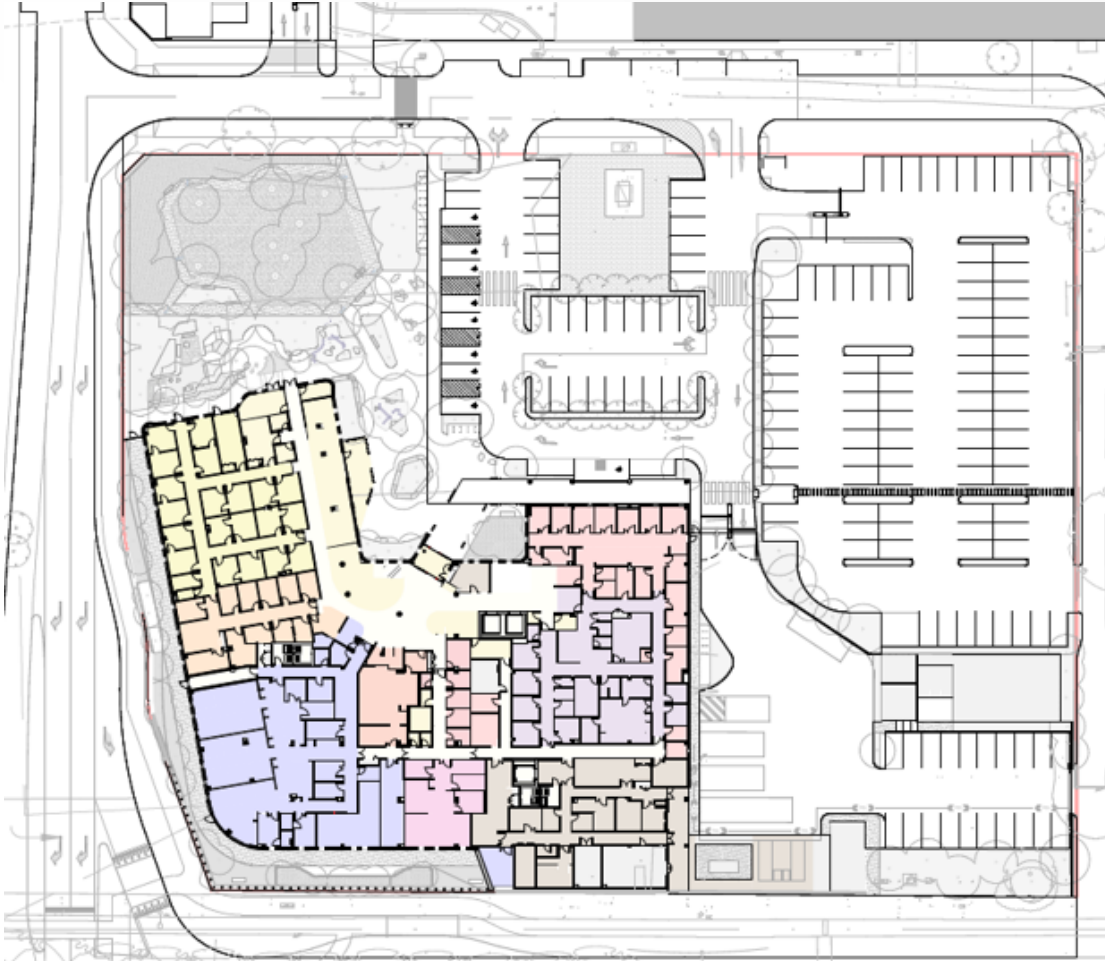

Cranbourne Community Hospital Site



Cranbourne will help take the pressure off major hospitals such as Casey Hospital. This will enable the major hospitals to focus on critical care, complex surgeries, emergencies and trauma.



Cranbourne Community Hospital

Located at the Casey Complex on
Berwick – Cranbourne Road

Finalising design development

Managing Contractor engaged by
the Victorian Health Building
Authority to deliver

**Early works construction:
commenced December 2021**

**Main works construction:
commencing shortly**

Expected completion: late 2024



Doubling our space

Indoors

- Around 9200 square metres, built over 3 storeys
- Carefully considered to create a safe and welcoming environment.
- Waiting and reception areas will 'bring the outside in' using natural light and plants.

Outdoors

- First Nations garden
- Nature play area
- Quiet healing garden



Services to be delivered

- Urgent Care Centre
- Dialysis
- Adult HITH
- Mental Health
- Dental
- Adult & Allied Health
- SECASA
- Child, Youth & Family
- Outpatients
- Ophthalmology
- Day Surgery (6 ORs)
- CSSD
- Pathology Collection
- Medical Imaging
- Pharmacy



Additional Points of Care

| Service | Cranbourne Integrated Care Centre POC | Future Hospital POC |
|----------------------------|---------------------------------------|---------------------|
| Urgent Care | 0 | 9 |
| Dialysis | 12 | 22 |
| Theatres | 2 | 6 |
| Hospital in the Home | 0 | 5 |
| Specialist Consulting | 17 | 19 |
| Primary & Community Health | 27 | 31 |
| Public Dental | 9 | 13 |
| Child, Youth & Family | 6 | 14 |
| SECASA | 3 | 3 |
| Mental Health & AOD | 12 | 24 |
| Medical Imaging | 1 | 7 |
| Pathology | 2 | 4 |
| TOTAL | 91 | 157 |



Cranbourne Community Hospital Ophthalmology

Christine Chen
Linda Santamaria



Build on an amazing team with a great track record

Cranbourne Day Surgery

- Delivered 3500+ / annum ophthalmic day surgery procedures and 600+ / annum other day surgeries pre COVID from CDS 2 theatre complex
- Expand to 6 theatre complex forecast to deliver 6500+ / annum ophthalmic day surgery procedures by 2033 + a range of other day surgeries e.g. gynaecology, colorectal

Specialist Consulting

- Delivered 6000+ / annum ophthalmology outpatient episodes from 6 shared consulting rooms
- Expand to 10 dedicated consulting rooms forecast to deliver 12000+ / annum ophthalmology outpatient episodes by 2033

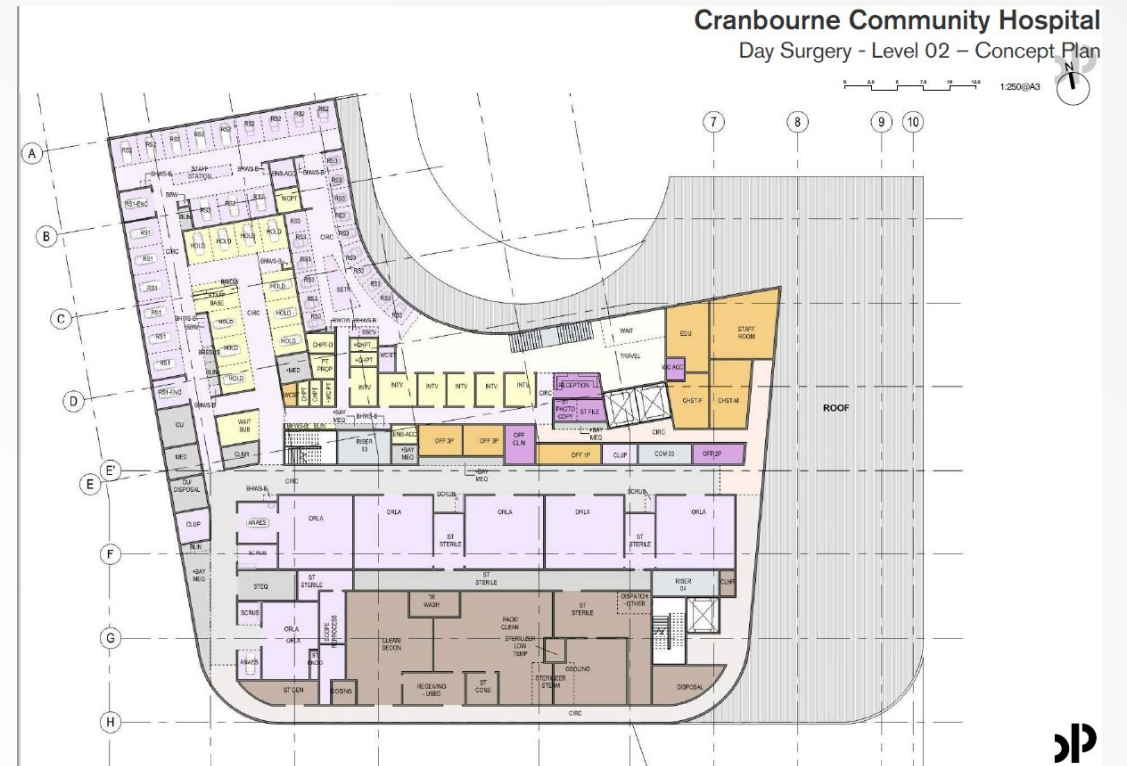

Cranbourne Day Surgery 6 theatre complex floor plan

Benefit the patients and the community we serve

Benefits for the patient:

- Bring excellent care closer to home
- Increase service capacity in the fastest population growth corridor.

Benefits for the community:

- Increase training capacity particularly for ophthalmologists and nurses
- Decentralise training of health care professionals with the hope to increase regional workforce.



Pauline Richards and Martin Foley Turning the Soil for the New Cranbourne Community Hospital 21 Dec 2021

Healthcare is a true team sport

Forecast and feasibility work started in Jun 2019

Funded in May 2021

Support:

- Execs: Andrew Stripp, Cath Cronin, Al Saunder and Julian Smith
- Capital: Anna Laird, Kayla Barfuss, Eddie Law
- Service Planning: Veronica Lehndorf

Collaboration:

- Anaesthetics: Blaine Robson, Mark Adams
- Nursing: Sarah Brighton, Rebecca Donald and team
- Medical, Surgical, Dental
- Support Services
- Allied Health
- Other projects: MCH, CASEY, RVEEH



Ophthalmology: Winner of Monash Health SMSA Golf Day 2018